

B-Pillar Mid Trim Left (Remove for Access and Install)



PROCEDURE

Remove

| | |
|-----|--|
| 1. | Remove the Left B-Pillar Mid Trim. Refer To: B-Pillar Mid Trim Left (Remove for Access and Install) |
| 2. | Move the Seatbelt Anchor Cover aside. |
| 3. | Loosen the bolt that attaches the Seatbelt Anchor Retrainer to the Seatbelt Anchor. |
| 4. | Move the Seatbelt Anchor retainer away from the Seatbelt Anchor. |
| 5. | Release the Seatbelt Anchor from the Seat. |
| 6. | Release the B-Pillar Trim from the two clips that attach it to the Body Frame. |
| 7. | Release the B-Pillar Trim from the two clips that attach it to the Body Frame. |
| 8. | Move the B-Pillar Trim down and away from the Roof Liner to release it from the B-Pillar Ramp. |
| 9. | Put the Seatbelt through the gap in the B-Pillar Trim. |
| 10. | Remove the B-Pillar Trim. |

Install

| | |
|-----|---|
| 11. | Move the B-Pillar Trim into position. |
| 12. | Put the Seatbelt through the gap in the B-Pillar Trim. |
| 13. | Install the B-Pillar Trim to the B-Pillar Ramp. |
| 14. | Install the B-Pillar Trim to the two clips that attach it to the Body Frame. |
| 15. | Install the B-Pillar Trim to the two clips that attach it to the Body Frame. |
| 16. | Install the Seatbelt Anchor to the Seat. |
| 17. | Install the Seatbelt Anchor Retainer to the Seatbelt Anchor. |
| 18. | Torque the bolt that attaches the Seatbelt Anchor Retainer to the Seatbelt Anchor to 8 Nm . |
| 19. | Move the Seatbelt Anchor Cover to its initial position. |
| 20. | Install the Left B-Pillar Mid Trim. Refer To: B-Pillar Mid Trim Left (Remove for Access and Install) |

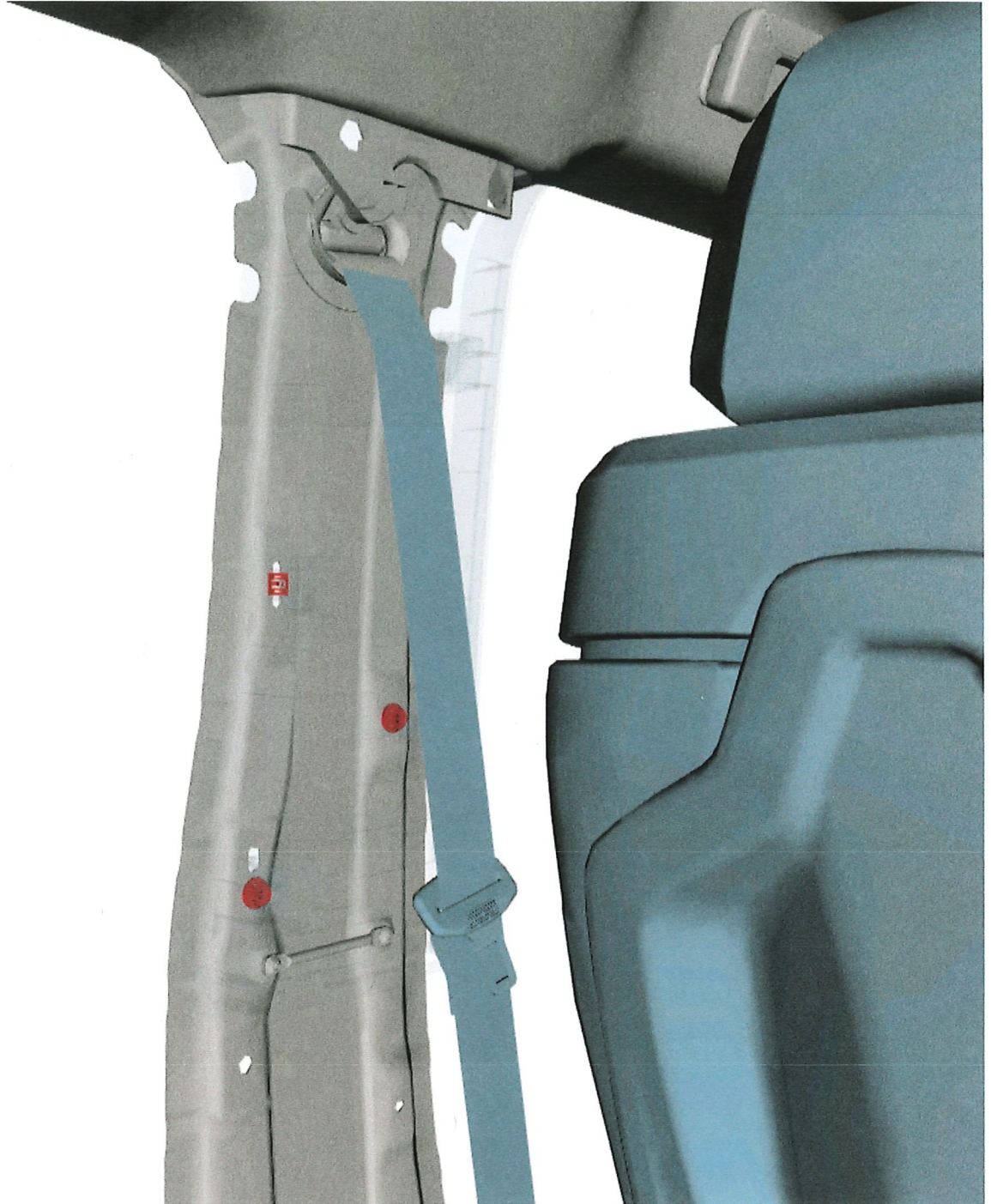

PROCEDURE

Remove

| | |
|----|--|
| 1. | Remove the Front Left Door Main-Seal Trailing Edge. Refer To: Door Main Seal Front Left Trailing Edge (Remove for Access and Install) |
| 2. | Remove the Rear Left Door Main-Seal Leading Edge. Refer To: Door Main Seal Rear Left Leading Edge (Remove for Access and Install) |
| 3. | Make sure the Passenger Seat is set to its forward position. |
| 4. | Move the Seatbelt aside. |
| 5. | Release the B-Pillar Mid Trim from the four clips that attach it to the B-Pillar Trims. |
| 6. | Release the B-Pillar Mid Trim from the three clips that attach it to the Body Frame. |
| 7. | Remove the B-Pillar Mid Trim. |
| 8. | Move the Seatbelt back to its initial position. |

Install

| | |
|-----|---|
| 9. | Move the Seatbelt aside. |
| 10. | Move the B-Pillar Mid Trim into position. |
| 11. | Install the B-Pillar Mid Trim to the three clips that attach it to the Body Frame. |
| 12. | Install the B-Pillar Mid Trim to the four clips that attach it to the B-Pillar Trims. |
| 13. | Move the Seatbelt back to its initial position. |
| 14. | Move the Passenger Seat to its initial position. |
| 15. | Install the Rear Left Door Main-Seal Leading Edge. Refer To: Door Main Seal Rear Left Leading Edge (Remove for Access and Install) |
| 16. | Install the Front Left Door Main-Seal Trailing Edge. Refer To: Door Main Seal Front Left Trailing Edge (Remove for Access and Install) |

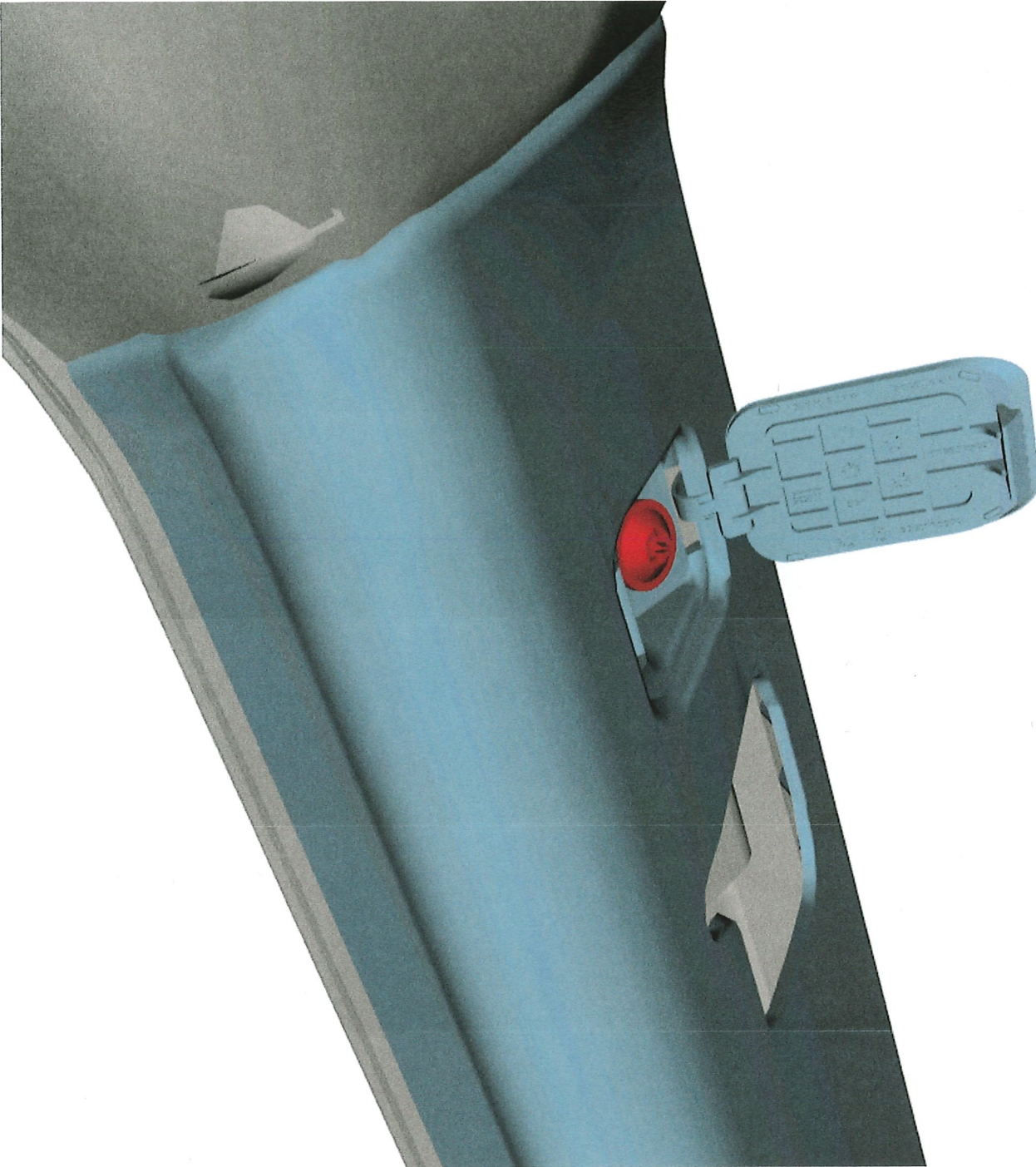

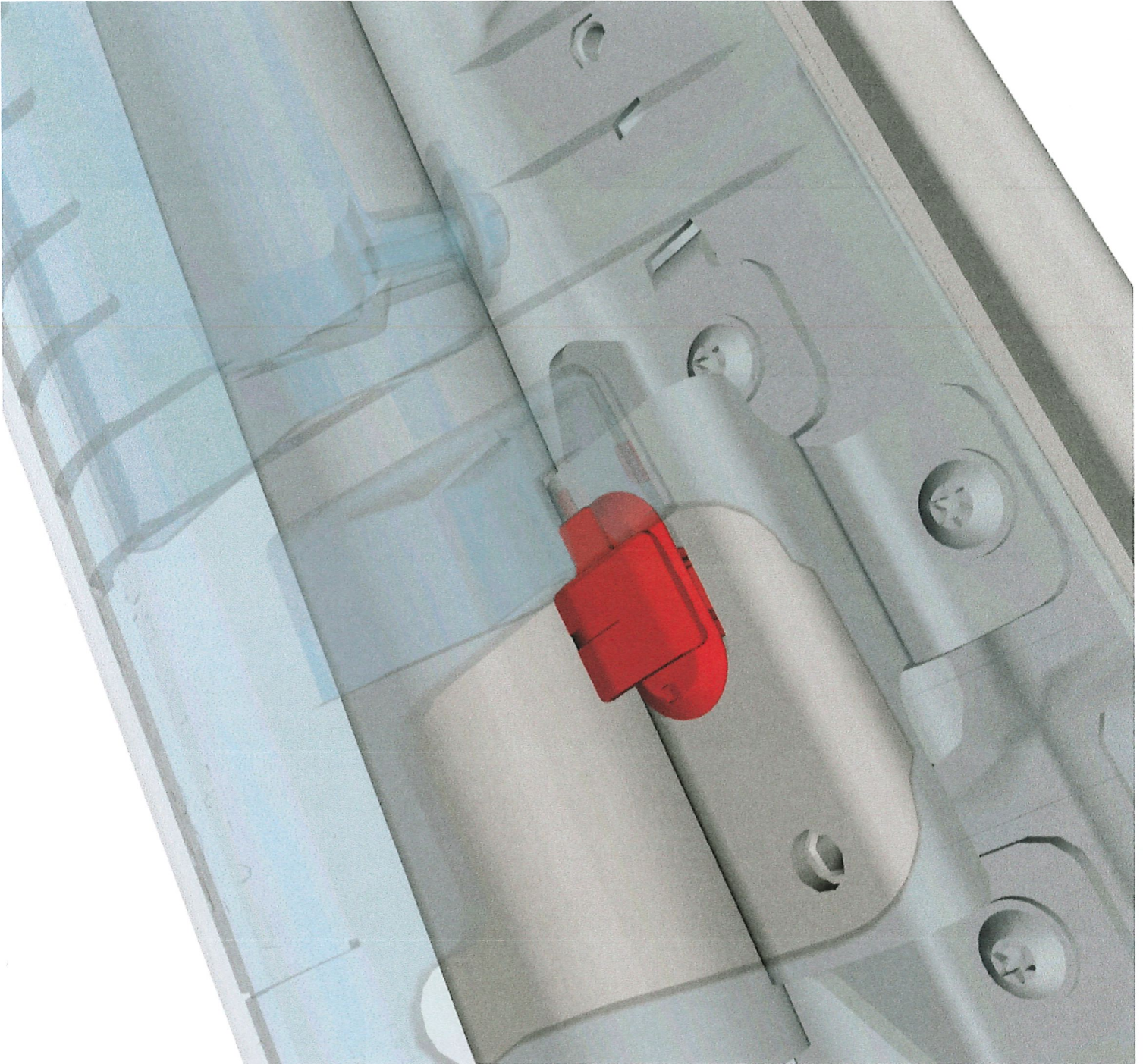



PROCEDURE

Remove

| | |
|----|---|
| 1. | Remove the A-Pillar Grab Handle. Refer To: A-Pillar Grab Handle LH (Remove for Access and Install) |
| 2. | Release the Door Seal from the Body Frame, only where the seal is adjacent to the A-Pillar Trim. |
| 3. | Move the Door Seal aside. |
| 4. | Release the Cover from the clip that attaches it to the A-Pillar Trim. |
| 5. | Move the Cover aside. |
| 6. | Remove the screw that attaches the A-Pillar Trim to the A-Pillar. |
| 7. | Move the top of the A-Pillar Trim away from the A-Pillar to disengage the Locating Tab. |
| 8. | Lift the A-Pillar Trim away from the Upper Console. |
| 9. | Remove the A-Pillar Trim. |

Install

| | |
|-----|--|
| 10. | Move the A-Pillar Trim into position. |
| 11. |  <i>NOTE: Make sure the A-Pillar Trim is correctly aligned to the clip that attaches it to the A-Pillar.</i> |
| | Lower the A-Pillar Trim down and to the Upper Console to install it to the clip that attaches it to the A-Pillar. |
| 12. | Move the top of the A-Pillar Trim to the A-Pillar to engage the Locating Tab. |
| 13. | Install and torque the screw that attaches the A-Pillar Trim to the A-Pillar to 8 Nm . |
| 14. | Move the Cover into position. |
| 15. | Install the Cover to the clip that attaches it to the A-Pillar Trim. |
| 16. | Move the Door Seal into position. |
| 17. | Install the Door Seal to the Body Frame. |
| 18. | Install the A-Pillar Grab Handle. Refer To: A-Pillar Grab Handle LH (Remove for Access and Install) |