



Ineos Grenadier seldom used but essential functions

Off Road mode.....	2
Wading Mode	2
Explanation Differential Locks.....	3
Downhill Assist.....	3
Rear-View Camera Activation	3
Winch Pairing.....	4
Winch Operation	4
Pathfinder Navigation Mode.....	5
Closing the Keyboard on the Infotainment Screen	6
Car Wash Function.....	7
Passenger Airbag Deactivation	7
Towing the car	8
Engine Oil.....	9
Snow Chains	9
SOS Emergency Call (eCALL)	10
Jump Start Procedure	11
Tip and tricks not in the manual	12

Off Road mode

Off-road Mode, can be activated by pressing the Off-road Mode button , located on the roof console.

To activate Off-road Mode, the vehicle must be stationary with the engine running and the handbrake on. The button has to be pressed for approximately one second, upon releasing the button, there is a fifteen second window to confirm activation of the Off-road Mode. To confirm, press the Off-road Mode button again and there will be an acoustic signal to confirm the activation has been completed. Once the activation has been confirmed there will be two tell-tale lamps illuminated, one being the Off-road Mode lamp

 and the other will be the ESC Off lamp . Furthermore, the infotainment unit will display a message, confirming the Off-road Mode activation and the button itself will illuminate a small LED.

To turn off the Off-road Mode, hold the Off-road Mode button  for at least one second and then release it. The button LED and the two tell-tale lamps will switch off, this will indicate that the Off-road Mode has been deactivated.

Wading Mode

TO ACTIVATE WADING MODE

- > Ensure vehicle is stationary with the engine on
- > Ensure the Transfer Case is in Low Range
- > Ensure the Centre Differential is locked
- > Press the Wading button in the Overhead Control Panel for 1 second
- > Press again within 15 seconds to confirm

Explanation Differential Locks

1. No diff locks = any one wheel slipping means you're stuck.
2. Centre diff locked = any one rear + one front wheel slipping = stuck.
3. Centre + rear diff locked = both rear wheels + one front wheel slipping means you're stuck.
4. Centre + rear + front diffs locked = all four wheels slipping = stuck.

Downhill Assist

Downhill Assist can only be activated, if the rear and/or front differentials are not engaged. In addition, the vehicle must not be travelling forwards above 15 mph (25 km/h), or reversing above 6 mph (10 km/h).

Press the Downhill Assist button  located in the overhead control panel to activate Downhill Assist.

Once activated, the infotainment screen will display the Downhill Assist symbol in green.

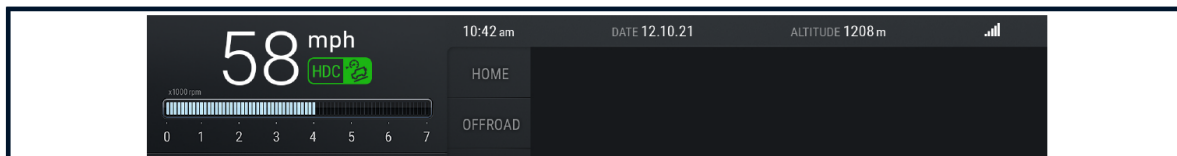

Rear-View Camera Activation

When the vehicle is in 'Off-road Mode' or 'Wading Mode' the reverse camera can be activated manually inside the off-road settings.

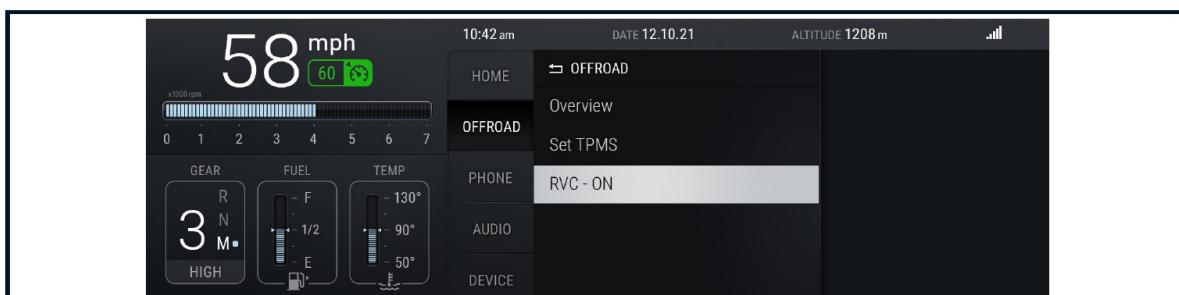

Winch Pairing

When the Winch is switched ON, the Winch Remote Control will be in pairing mode for five seconds. Ensure there is no other Winch switched ON simultaneously, in the vicinity.

1. Start the engine.
2. Engage Neutral (N) and the handbrake.
3. Check the Winch isolator in the Overhead Control Panel is set to OFF.
4. Switch the Winch Remote Control ON.
5. Hold the IN and OUT buttons on the Winch Remote Control simultaneously.
6. Switch the Winch isolator in the Overhead Control Panel to ON.
7. Continue to hold the IN and OUT buttons on the Winch Remote Control simultaneously, for three seconds.
8. Release the IN and OUT buttons on the Winch Remote Control.
9. Test the Winch Remote Control functionality.

Winch Operation

1. Start engine
2. Toggle 500A EXT4 winch switch
3. Gear selector in "N"
4. Engage handbrake
5. Hold Power Button of Remote Control for 3 seconds
6. Freespool Lever in horizontal position
7. Pull the Winch Rope out
8. Freespool Lever in vertical position (clockwise)
9. Spool the Winch (pretension)
10. To move the vehicle while operating the Winch, disengage the handbrake and set the transmission to N, R, or D
11. Operate the Winch

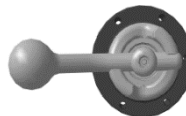

Pathfinder Navigation Mode

Record Path

The record path screen, may be used to record the path driven manually or automatically.

The user can add a way point by clicking on the record path button, otherwise the user can add a way point automatically. To automatically add way points over set distances, the user should switch on the automatic feature inside the menu options.

In the image below, the compass shows the direction of travel and the distance travelled.



Pathfinder File Transfer

The 'PATHFINDER FILE TRANSFER' menu consists of the following options:

- > USB A
- > USB C
- > Hard Disk Drive (HDD)

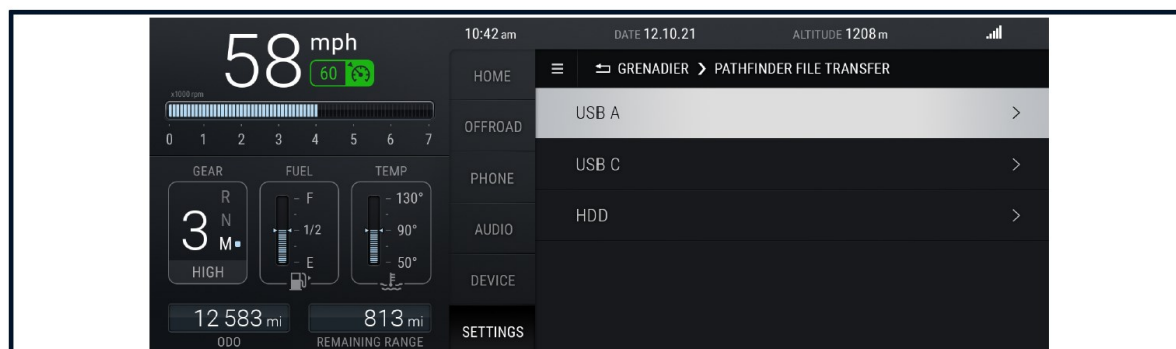

Follow Path

Once the user has recorded the path required, the path can be followed using the recorded way points. When the user clicks on the next way point, the compass will navigate the user in the direction required, to reach the next way point. While following the compass direction, the user can see the distance to reach the next way point selected.



The user can select the next way point required or revert back to a previous way point by pressing the 'NEXT WAYPOINT' or 'PREVIOUS WAYPOINT' buttons on the infotainment screen. The user can also select the way point markers on the route line, by either pressing the infotainment screen or by using the rotary controls.

Closing the Keyboard on the Infotainment Screen

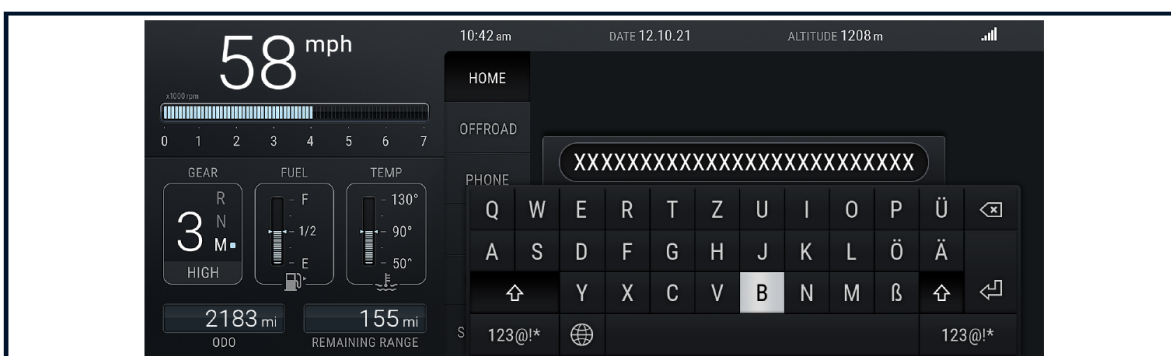

To close the keyboard, press the 'BACK' button on the CCI or touch anywhere outside the keyboard.

Car Wash Function

The process below puts the vehicle into a state for safe rolling.

1. Put the transmission into N while pushing the brake pedal.
2. Stop the engine.
3. Immediately turn on the ignition without starting the engine.
4. Now "car wash function" is engaged and the vehicle can be pushed.



NOTE: If the ignition is not switched on the Park position will be engaged after several minutes.

If there is a malfunction, you may not be able to change the gears. If this happens call the nearest INEOS approved partner for support.

Passenger Airbag Deactivation

To deactivate the passenger airbag make sure the handbrake has been engaged and the vehicle is in gear park (P). Do not press the brake pedal at this time.

Press the 'Passenger Airbag' button using the infotainment system. This will then prompt you to press the brake pedal for three seconds. You will receive a confirmation on the infotainment system that the airbag has been disabled.

If there is no confirmation, do not assume the airbag is deactivated. Try the process again from the beginning. If the confirmation fails to appear again then contact an INEOS approved partner and do not install any child restraint to the front passenger seat.

Towing the car

The two-speed transfer case can be put into neutral, in order to tow or roll the vehicle. First, the vehicle must be secured with chocks, this will stop the vehicle rolling. Secondly, from underneath the vehicle, located on the transfer box, is the 'neutral screw'. The screw must be rotated clock-wise, screwing inwards until it can't go any further. Once the screw has been screwed in, as far as possible, the vehicle will be in a neutral state.

The 'neutral screw' can be identified by the word 'NEUTRAL' and a directional arrow, both visible on the casing. This will confirm the clockwise rotation, to achieve the neutral status of the vehicle.

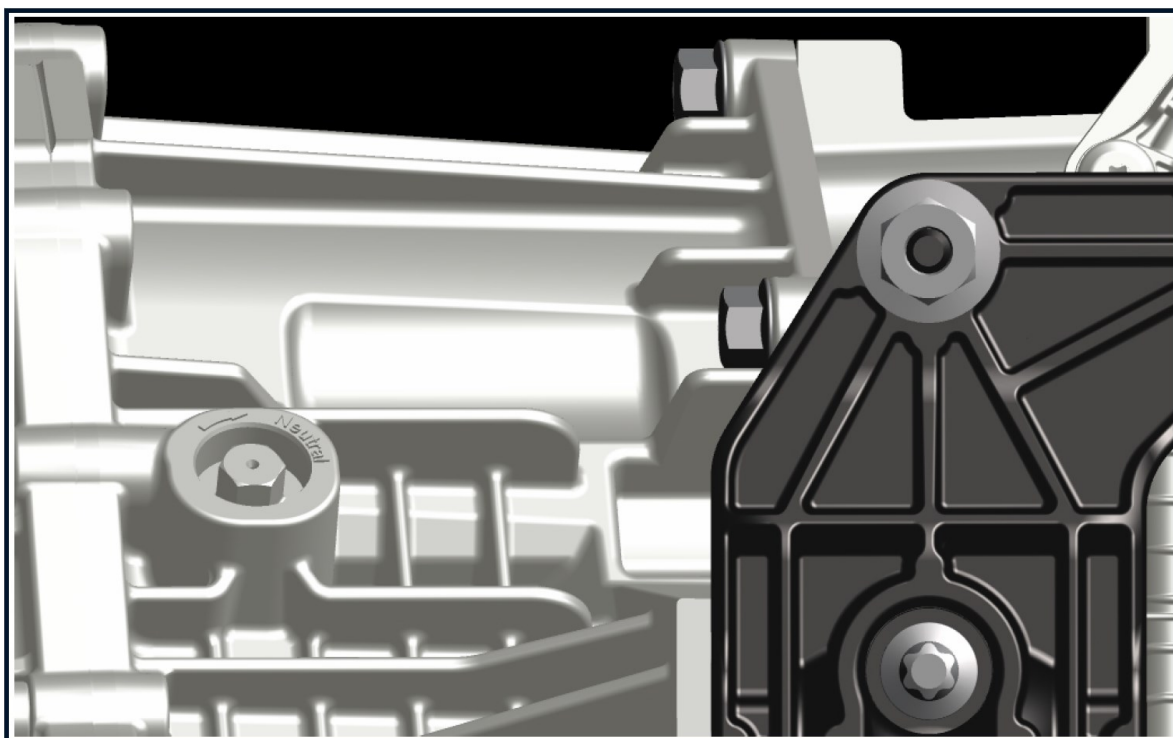

NOTE: Try to engage 'HIGH' or 'LOW', to be certain that the neutral status of the vehicle has been achieved.



WARNING: When removing the vehicle from neutral after towing or rolling, it is important that the screw is rotated anti-clockwise, but only until the screw head is flat and flush with the transfer box casing. Any more than this will result in severe damage to the two-speed transfer case.

1. Select neutral position in the automatic gearbox.
2. Set the differential to the unlocked position.
3. Rotate the neutralisation bolt clockwise in order to engage neutral. The bolt is located in the side of the transfer case.
4. Turn the key in the ignition barrel to position one, this will then unlock the steering column.
5. Release the handbrake.



NOTE: The key must remain in position while towing, do not try to change the position of the key in the ignition barrel, until towing has finished and the vehicle is stationary.

Engine Oil

PETROL B58	SERVICE FILL
Volume @ 15 °C	6,5 L
Engine Oil	0W20
Recommended Engine Oil	Titan EM BMW 4615E-0W

Snow Chains

Snow chains available for the vehicle:

- > A 82 S AUSTRO-S
- > XMR 82 V BRENTA-C 4x4

It is recommended that snow chains are used on both axles, all four wheels. Alternatively, install snow chains to the rear wheels

SOS Emergency Call (eCALL)

Manual Operation

To Manually operate the emergency call system:

1. Open the eCall switch cover, located in the roof console.
2. Press and hold the button, until the green LED flashes.
3. After eight seconds, the vehicle will dial a emergency call operative to assist.

Manually operate the eCall system, in the event of an accident not severe enough to deploy airbags, but still requires assistance from the emergency services. Or, if there is an incident, that does not involve yourself but the emergency services are required, such as, an accident next to your vehicle.



NOTE: The emergency call function, should only be used if you or others are in need of emergency assistance. The function is not for use in the event of a breakdown or any other similar non-emergency situations.

Automatic Operation

The eCall system is directly connected to the occupant restraint control system (ORC). When there is an incident or road collision with airbag deployment, the eCall system will automatically contact an emergency operative to advise. The operating Center will also receive a text message with information, such as, current location.

Jump Start Procedure

1. Park the donor vehicle as close as possible, The vehicle batteries should be adjacent to each other, this reduces the space that the jump cables need to cross to connect the batteries.
2. Make sure the handbrake is applied to both vehicles.
3. The donor vehicle should be in neutral gear or park **P** if automatic.
4. Make sure both vehicles are switched off.
5. Connect the positive (+) cable to the positive (+) terminal, on the donor vehicle battery. Then connect the other end of the positive (+) cable to the positive (+) terminal on the vehicle with the depleted battery.
6. Connect the negative (-) cable to the negative (-) terminal on the donor vehicle.



WARNING: Do not connect the last remaining negative (-) cable to the negative (-) terminal on the vehicle with the discharged battery. Only connect the last remaining negative (-) cable to an earth point for safety reasons.

7. Connect the last remaining negative (-) connector, to an earth point, on the vehicle with the discharged battery.
8. Check the connections are secure and in the correct positions. Check that the cables are not caught on any moving or mechanical parts. Now start the donor vehicle engine and run at about 1500-2000 rpm for two to three minutes.
9. Now start the vehicle with the discharged battery, allowing both engines to run together for a further two minutes.
10. Switch the donor vehicle off.
11. Disconnect the negative (-) cables first, followed by the positive (+) cables from both vehicles.

Tip and tricks not in the manual

- Double click the key fob when locking the vehicle cuts out all the lights (both interior & exterior) immediately.
- Workaround for powering the Winch or NATO plug with motor off : use the "car wash mode".

(version 11/10/2023)

P221

- > Failure or unreasonable delay in having the vehicle repaired at the earliest opportunity after a defect has become apparent.

P189 check : The High Load Auxiliary Switch Panel & Electrical Preparation ... 25A outlet at the rear of the vehicle

P159 check : daytime Running Light on or off